

# 08

## PASAR JAWA: SPECIAL AREA PLAN (SAP) FOR KLANG ROYAL TOWN, SELANGOR

Wan Ramlah Wan Mohamad, M. Zainora Asmawi & Nur Li Izyani Muhamad  
Department of Urban and Regional Planning, Kulliyah of Architecture and Environmental Design, IIUM

### ABSTRACT

The project aims to design the Special Area Plan (SAP) for Pasar Jawa Klang Selangor. The newly proposed J-Market Square Park will be the new commercial area. This market square is designed to create a new landmark and promote tourism activities. The supporting facilities such as pergola, bins, water fountain and lamp post are designed in several designated areas include seating area, eating area, food hub and walkable area.



Figure 1 Key plan

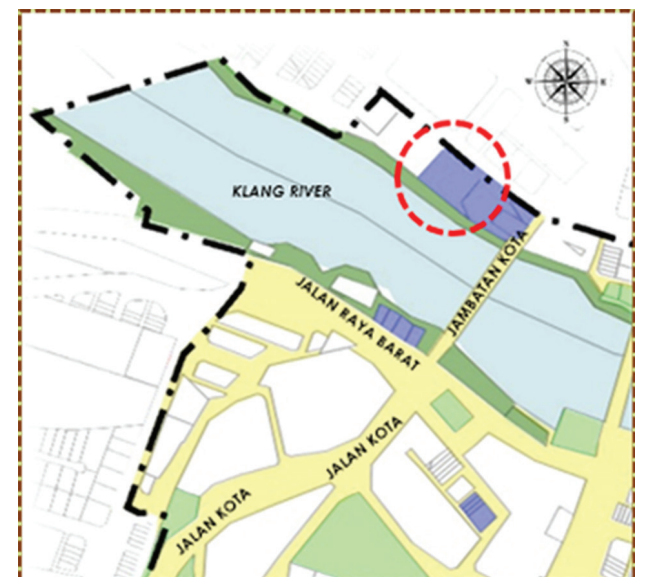

Figure 2 Location Plan

### INTRODUCTION

The proposed J'- MARKET SQUARE PARK is located at the cultural zone, known as Pasar Jawa. Generally, this proposal includes the process of rejuvenating Pasar Jawa as one of the commercial area for Malay products, especially chips.

### OBJECTIVES

1. Attracts more visitors at any time
2. Provides more social interaction and walking zone
3. Ensures a liveable built environments, healthy lives
4. Attracts young adults, families, youths and children.
5. A desirable places to spend time in, to meet others
6. Offers citizens and tourists various opportunities for activity
7. Able to enjoy nice landscape, great human scale environments - streetscapes that promote leisure and enjoyable walks
8. Safe environment and active areas
9. Creates new attraction for Pasar Jawa in promoting the uniqueness of existing culture and local products for visitors - portable kiosks and the Pasar Jawa itself.



## ISSUES

The number of tourists is not encouraging due to the lack of promotion on tourism resources and products, such as; advertisement towards local and foreign tourists.

## POTENTIALS

The existence of commercial activities at the strategic area ; Little India and Pasar Jawa

## DESIGN DESCRIPTIONS

### SOFTSCAPE ELEMENTS



Figure 3 J-Market Square Park



#### 1. PERGOLA

Forming a shaded walkway, and sitting area with a sturdy open lattice.



#### 2. BINS

Are placed alongside paths frequently walked by visitors, encourages people to avoid littering.



#### 3. WATER FEATURE

Versatil feature for a landscape enjoyed by all ages, improve environment of the site.



#### 4. WATER FOUNTAIN

Calm and soothing area and as an add aesthetic value for landscape and nearby building.

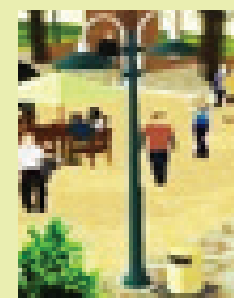

#### 5. LAMP POST

Increase in safety along the sidewalk for pedestrians.

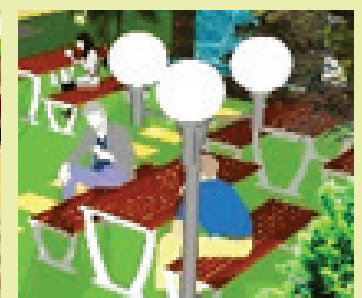

#### 6. GARDEN POLE LIGHT

To enhance night environment, increase safety, night-time aesthetics, accessibility, security, recreation and sports, and social activities.



## DESIGN DESCRIPTIONS ACTIVITIES

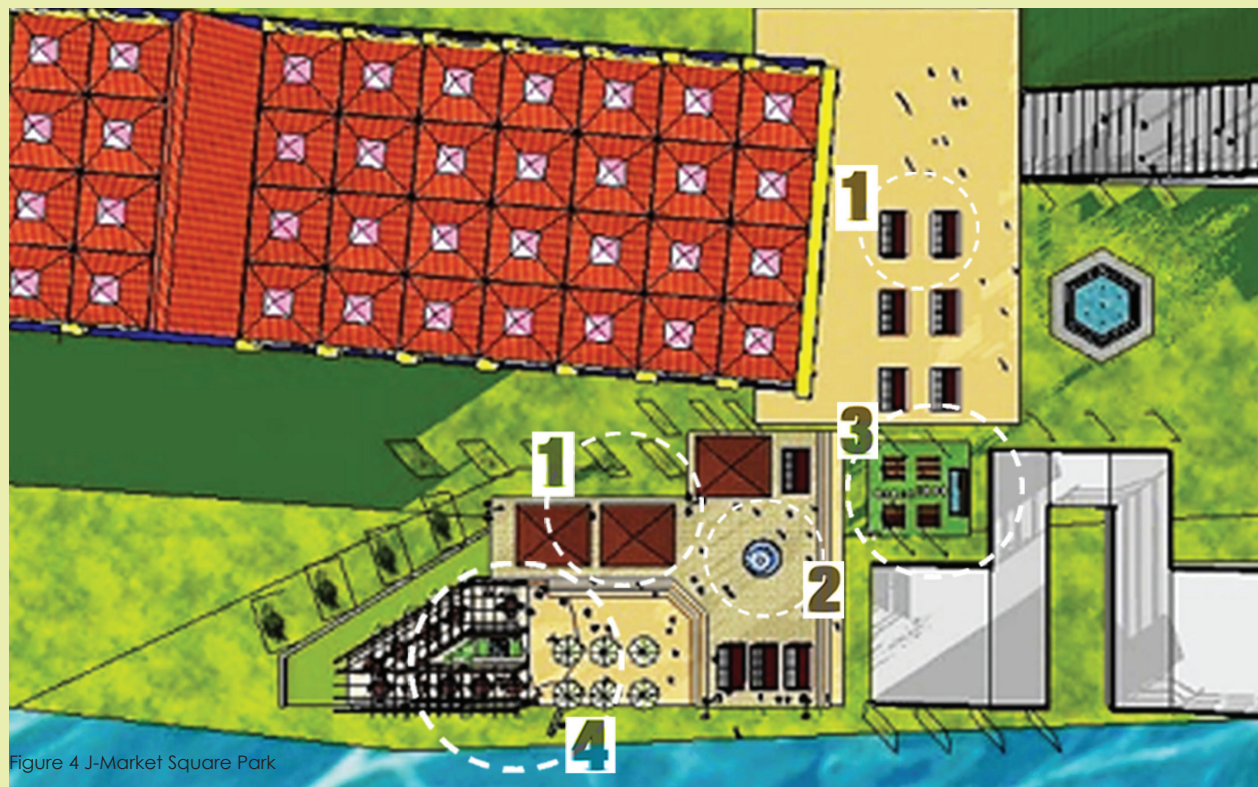

Figure 4 J-Market Square Park

3



### SEATING AREA

- An area for people to sit and have social interaction

4



### EATING AREA

- Designed for people to enjoy food while experiencing and viewing the water symphony at the F-BIE' Edge Jetty, Klang river.  
- The eating area gives comfort to visitors due to the soothing sounds of water elements in the surrounding.  
- Attractive landscape designed on the site can boost more visitors to make this eating area as their main choice while visiting the place.

1



### FOOD HUB

- To attract local and foreign tourists to enjoy the uniqueness of local food such as Indian and Javanese cuisine  
- Permanent kiosks will provide main dish of each type of food. Portable kiosks will serve fingers food and other instants food and beverages.

2



### WALKABLE AREA

- Promotes health, environmental, and economic benefits.  
- The site complete with street furniture, as well as offers the beauty of landscape and built environment.





## REFERENCES

Jabatan Perancangan Bandar dan Desa (2016). Dasar Perbandaran Negara Kedua. Jabatan Perancangan Bandar dan Desa Semenanjung Malaysia.

Jabatan Perancangan Bandar dan Desa (2016). Rancangan Fizikal Negara Ke-3. Jabatan Perancangan Bandar dan Desa.

Jabatan Perancangan Bandar dan Desa Negeri Selangor (2007). Rancangan Struktur Negeri Selangor 2020. Jabatan Perancangan Bandar dan Desa Negeri Selangor

Jabatan Perancangan Bandar dan Desa Negeri Selangor (2016). Manual Garis Panduan & Piawaian Perancangan Negeri Selangor Edisi Ketiga. Jabatan Perancangan Bandar dan Desa Negeri Selangor.

Ministry of Tourism and Culture Malaysia. (2014). Malaysia Tourism. Ministry of Tourism and Culture Malaysia.

Ministry of Tourism and Culture Malaysia. (2015). Malaysia Tourism. Ministry of Tourism and Culture Malaysia.