

# 02

## SHARI'AH COMPLIANT HEALTHCARE CENTRE

Ismail Jasmani, Mohd Izzat Amir Zakaria & Julaila Abdul Rahman  
Department of Applied Arts and Design, Kulliyah of Architecture and Environmental Design, IIUM

### ABSTRACT

Designing a building based on Shari'ah compliant practice is encouraged in Islamic Community. Hospitals are where people who get medicine or proper treatments sick. This institution or health care service where dealing with inpatient, outpatient and emergency cases. In Malaysia Department of Standard has been appointed Standard and Industrial Research Institute of Malaysia (SIRIM) as one body to develop, distribute, evaluate and certify standard in Malaysia. Under General Shari'ah based Quality Management System (MS 1900:2014). MS 1900:2014 documents are specifically provide general guideline to-

ward implementing a shari'ah management system. A Shari'ah compliant hospital is where the healthcare services rendered in the hospital are in accordance with the Islamic Teaching principle. The awareness for the need to practice Shari'ah Compliant in all aspect in Islam practices are importance now day, where the beauty of Islam way of life and everyone can practice without bias to one races and community in all aspect in way of life in the world.



Figure 1 – Proposal of New Lobby Healthcare Centre: Outpatient Unit with Shari'ah Compliant

Islam allows its follower to accept brands that are 'halal' or called as 'Shari'ah' compliant. This research proposed an interior design of a hospital according to 'Shari'ah' compliant in elements such as space planning, orientations, color, furniture arrangements, as well as hospital management's operation system.

This research focused more on space and spatial planning, designing the furniture and arrangement of furniture and color selection to meet the 'Shari'ah' compliant for Healthcare Centre for Outpatient unit.

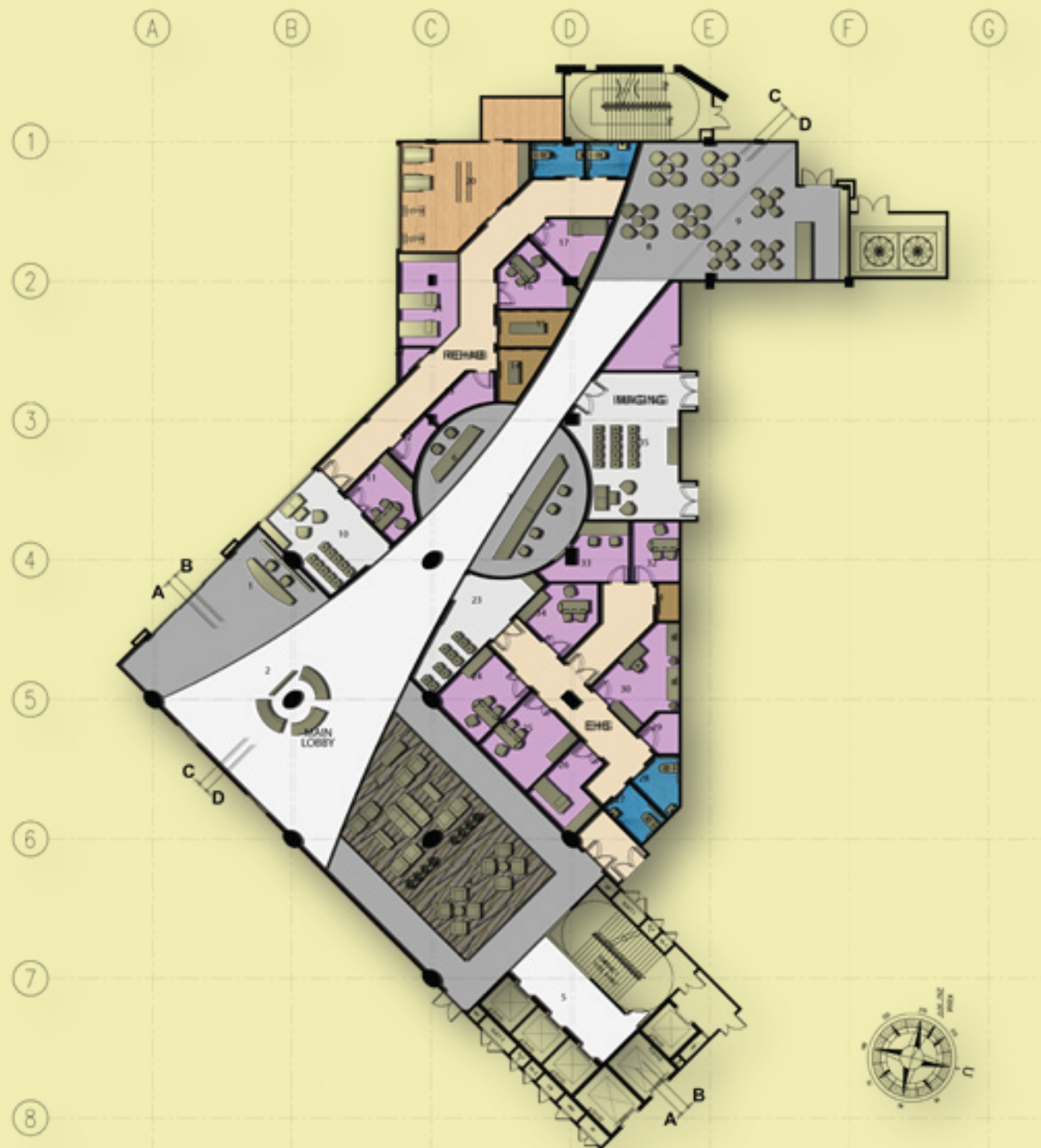

Figure 2 Design layout plan proposal



Figure 5 Corridor and lounge area with implemented of natural element



Figure 7 Hall way to café area



Figure 8 Mood Board and Proposal of Material Selection



Figure 9 Main Lobby

## CONCLUSION

'Shari'ah' Compliant Hospital does not only cater for the physical treatments of the patient, but it also caters and provide for the religious and spiritual needs of a Muslim patient. Currently, the understanding and acceptance of spirituality and religiosity in public facility; hospital is still not acknowledge by Oriental culture as well as Western world. This research approaches on 'Shari'ah' Compliant is recommended to be a part of Medical Tourism Industry, targeting OIC members countries. In relation, it can be seen that Malaysia is one of the country that has a potential as one of the hub of hospital tourism industry in the near future.

## REFERENCES

- 1.Chang, W. Y., Ma, J. C., Chiu, H. T., Lin, K. C., & Lee, P. H. (2009). Job satisfaction and perceptions of quality of patient care, collaboration and teamwork in acute care hospitals. *Journal of advanced nursing*, 65(9), 1946-1955.
- 2.Dargahi, H. (2011). The Implementation of the Sharia Law in Medical Practice: A Balance between Medical Ethics and Patients Rights. *Journal of medical ethics and history of medicine*, 4.
- 3.Erbay, M. (2013). EFFECT OF USE OF COLOR ON PERCEPTION: EXAMPLE OF ENTRANCE AREA IN HEALTHCARE BUILDINGS. *International Journal of Academic Research*, 5(3)
- 4.Ferenc, J. (2010). Floored!. *Health facilities management*, 23(9), 38-42.
- 5.Jais, A. S. THE HEALTHCARE TOURISM: FEASIBILITY AND FUTURE OUTLOOK FOR MALAYSIA.
- 6.Jasmani, I. (2013). Interior design elements and facilities for disabled people in the mosque: are we facilitating the" needs"?. *UNIVERSAL DESIGN AND ACCESSIBILITY*, 1-26.
- 7.Jones, P. (2004). *The arts therapies: A revolution in healthcare*. Routledge.
- 8.Marcus, C. C., & Barnes, M. (Eds.). (1999). *Healing gardens: Therapeutic benefits and design recommendations (Vol. 4)*. John Wiley & Sons.
- 9.Mortada, H. (2003). *Traditional Islamic principles of built environment*. Routledge.
- 10.Mohezar, S., Zailani, S., & Moghavvemi, S. (2014). Establishing Islamic medical tourism in Malaysia: Understanding the motivations and challenges.
- 11.Omer, S. (2008). Towards understanding Islamic architecture. *Islamic Studies*, 483-510.
- 12.Othman, R., Md Hashim, M. H. A., & Jasmani, I. (2015). Shariah Compliance Space Planning for Hotel Room Design. *World Academy of Science, Engineering and Technology, International Journal of Civil, Environmental, Structural, Construction and Architectural Engineering*, 9(10), 1308-1314.
- 13.Porter, M. E. (2009). A strategy for health care reform—toward a value-based system. *New England Journal of Medicine*, 361(2), 109-112.
- 14.Saifuddin, S., Othman, R., Hashim, M., Akmal, M. H., Jasmani, I., Majid, A., & Hanita, N. (2015). Shariah compliance space planning for hotel room design